



# Dornbracht eUnit Kitchen

## Manual

4	General information	14	Product configurations
20	Cleaning	14	Logic controls
21	Service Display	14	Display Button
21	Waiting display	15	Rotary knob
22	Maintenance	16	Functions
22	Safety deactivation	16	On/Off
22	Disposal	18	Volume adjustment
14	Display Button	19	Temperature adjustment
15	Rotary knob	20	Strainer waste control
16	On/Off	20	Flow volume control
19	Temperature adjustment	20	Cleaning
18	Volume adjustment	21	Service Display
20	Strainer waste control	21	Waiting display
20	Flow volume control	22	Maintenance
12	Safety information	22	Safety deactivation



Please read this operating manual in full before using the eUNIT KITCHEN for the first time.  
Other language versions are available on the Internet at:



[dornbracht.com/eUnit](http://dornbracht.com/eUnit)

Typ: eUnit Kitchen  
Power consumption: max. 18 W  
Nominal voltage: 100 - 240 V ~ 50 - 60 Hz  
Nominal current: 0,6 A  
Protection (control elements): IP X4  
Protection (Motherboard and eValve): IP X4



Aloys F. Dornbracht GmbH & Co. KG Armaturenfabrik  
Köbbingser Mühle 6, D-58640 Iserlohn  
Tel. +49(0)2371 433-0, Fax +49(0)2371 433-232  
mail@dornbracht.de, dornbracht.com

## Dornbracht Group

Premium Solutions for Interior Architecture

# General information

## Cleaning

Key lock

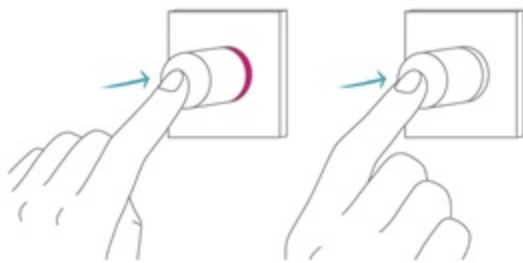

5 sec.



## Service Display

If one of the symbols is lit in red for 2 seconds, contact your dealer or the Dornbracht Service Department.



## Waiting display

If a function has been selected but is not yet ready (e.g. the set temperature), the appropriate symbol will flash. It will stop flashing as soon as the function is ready for use.



## Maintenance

We recommend that you have all the components inspected and serviced by your plumber once per year. This maintenance will also include cleaning, checking for leaks, checking the functions and uploading the latest software version. A maintenance contract with an authorised plumber will ensure that your system is inspected regularly.

## Safety deactivation

A safety deactivation system ensures that all active functions are switched off automatically after 30 minutes at the most.

## Disposal

All electronic elements are marked in compliance with European Directive 2002/96/EC on Waste Electrical and Electronic Equipment (WEEE). This Directive provides the framework for the return and recycling of end of life products throughout the EU. In addition to valuable recyclable materials, end of life electrical and electronic appliances also contain harmful substances. These can be harmful to human health and the environment if they are disposed of in the residual non-recyclable waste or if they are not treated correctly. You should therefore never dispose of your waste appliance as non-recyclable waste. Instead, use the collection point established by your local authority to return and recycle electrical and electronic waste. Ensure that you comply with the current regulations in this respect. You must also comply with other national regulations which apply.



Freely positioned



Integrated in the sink unit

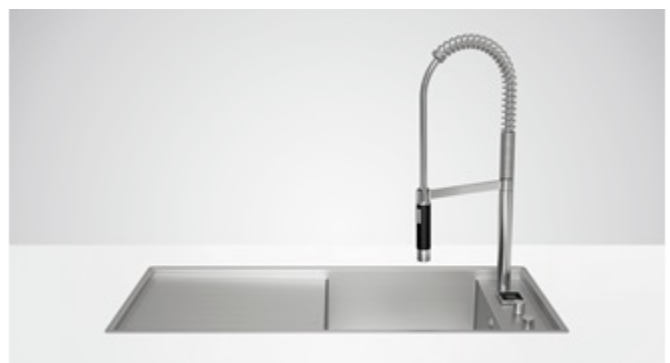

## Display Button

1 = Water On / Off

2 = Flow volume control 0,1–0,9 l

3 = Strainer waste Close / Open

4 = Flow volume control 1–9 l

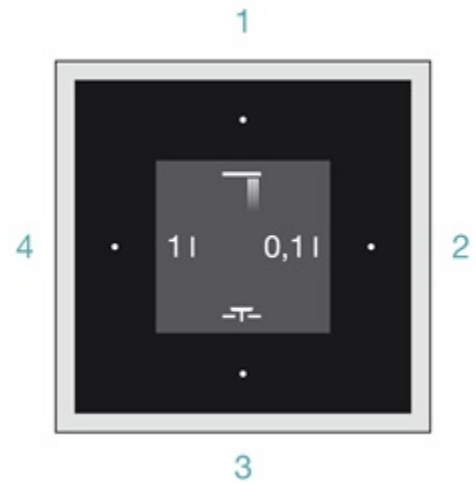

## Rotary knob

Volume

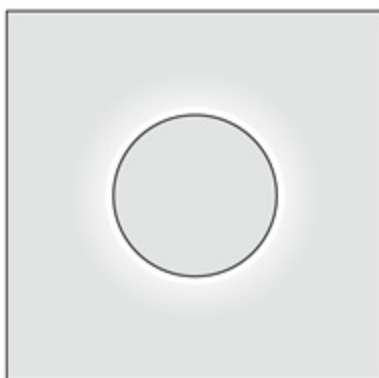

Temperature

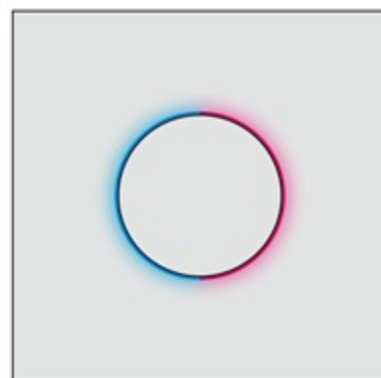



The eUNIT KITCHEN has an automatic sleep mode. The system can be woken up and made ready for use by pressing or turning any control element. If it is not used for 60 minutes, the system (including the foot sensor) will return to automatic sleep mode. The pre-defined water volume is 80%, the pre-defined temperature 28°C. Individual settings are saved for five minutes after the water has been switched off.

Ready



Sleep mode

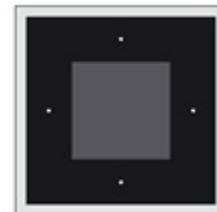

## On/Off

using rotary knob

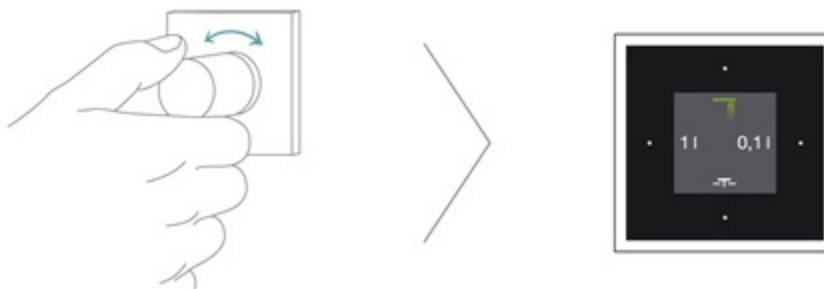

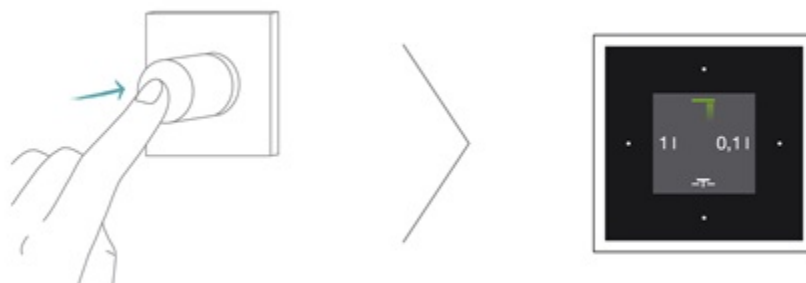

using display button

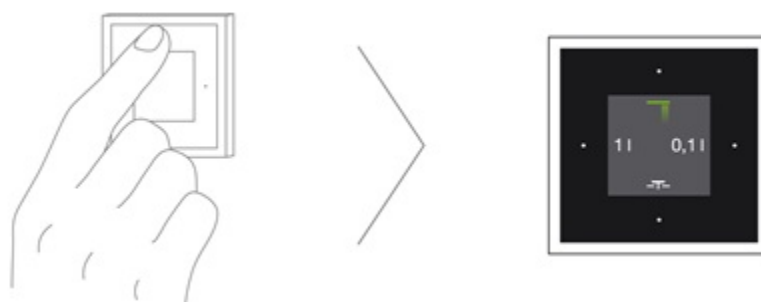

using foot sensor



## Temperature adjustment

### Temperature adjustment

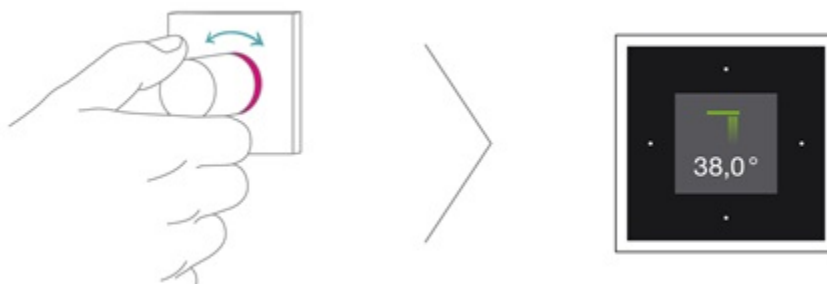

### Disable scalding protection system

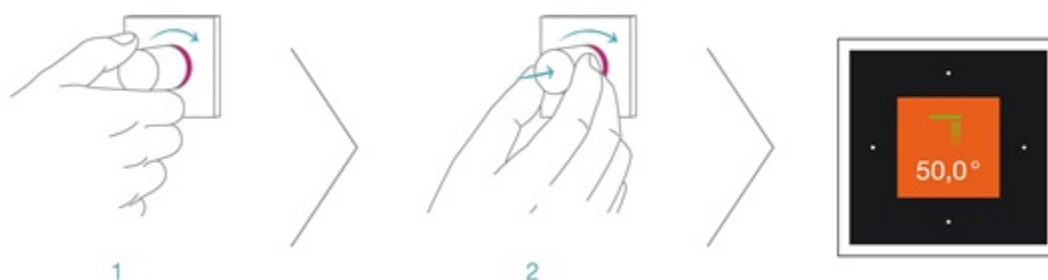

1 = turn to max

2= push + turn at the same time



The scald protection system will be re-enabled after 10 minutes.

## Volume adjustment

Volume

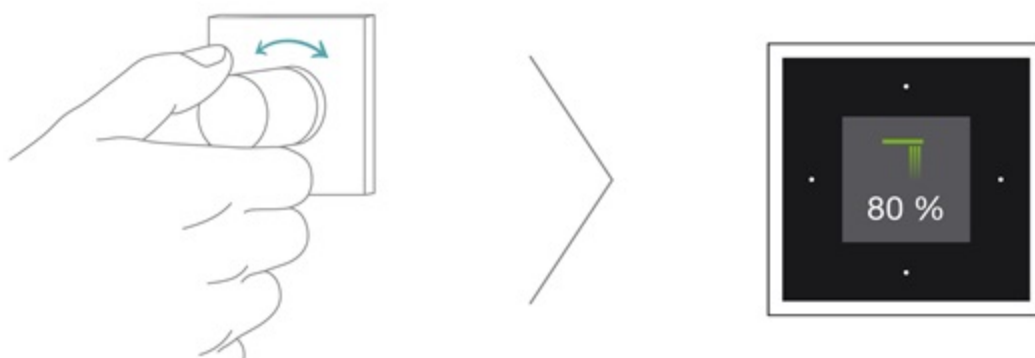

## Strainer waste control

Close / Open

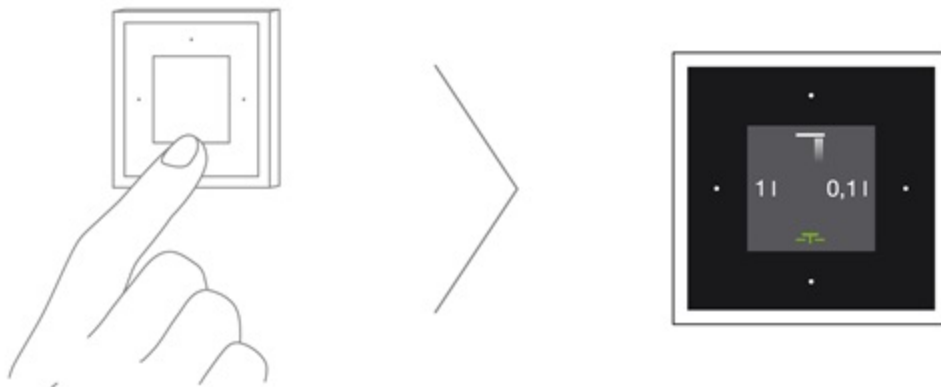

## Flow volume control

Pressing the left key several times enables you to select between 1.0 and 9.0 l.  
Pressing the right key several times enables you to select between 0.1 and 0.9 l.

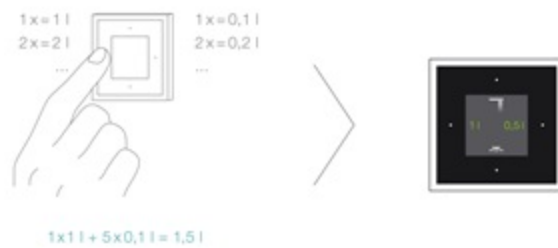

## Safety information

The eUNIT KITCHEN can be used by children of 8 years old and over, and also by persons with restricted physical, sensory or mental capacity or lack of experience and knowledge, if they are supervised or have been instructed on safe use of the appliance and understand the resulting risks. Children must not be allowed to play with the appliance. Cleaning and maintenance must not be carried out by children without supervision.

# Product configurations

Freely positioned



Integrated in the sink unit



# Logic controls

## Display Button

- 1 = Water On / Off
- 2 = Flow volume control 0,1–0,9 l
- 3 = Strainer waste Close / Open
- 4 = Flow volume control 1–9 l

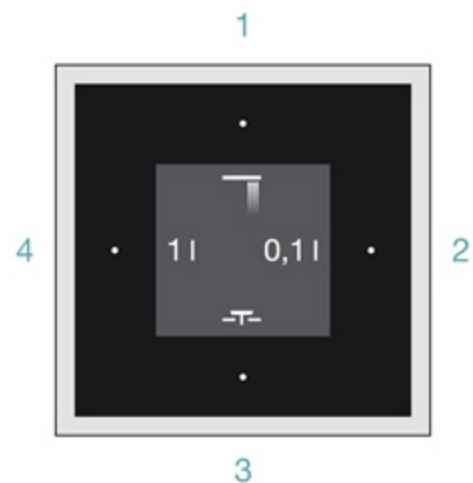

## Rotary knob

Volume

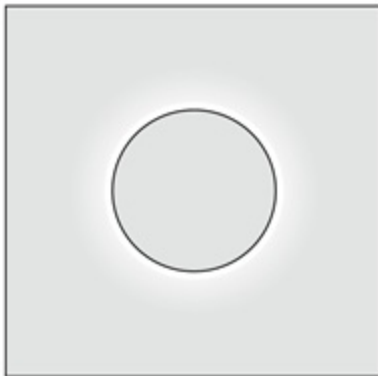

Temperature

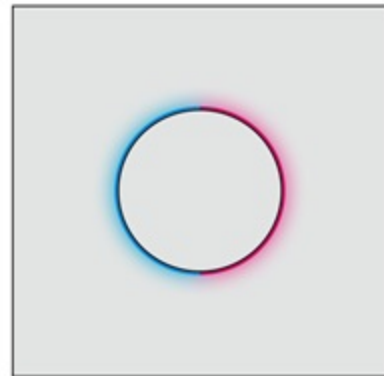



# Functions

The eUNIT KITCHEN has an automatic sleep mode. The system can be woken up and made ready for use by pressing or turning any control element. If it is not used for 60 minutes, the system (including the foot sensor) will return to automatic sleep mode. The pre-defined water volume is 80%, the pre-defined temperature 28°C. Individual settings are saved for five minutes after the water has been switched off.

Ready



Sleep mode



## On/Off

using rotary knob

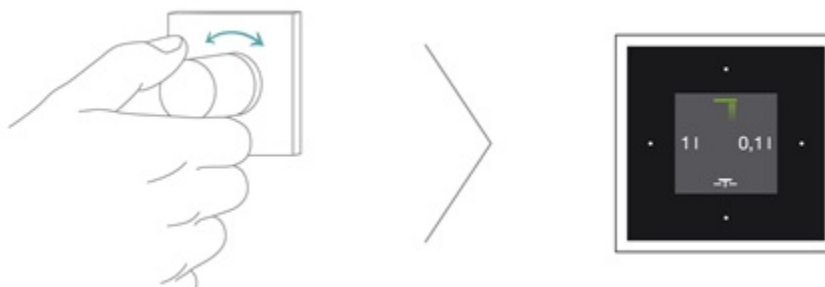

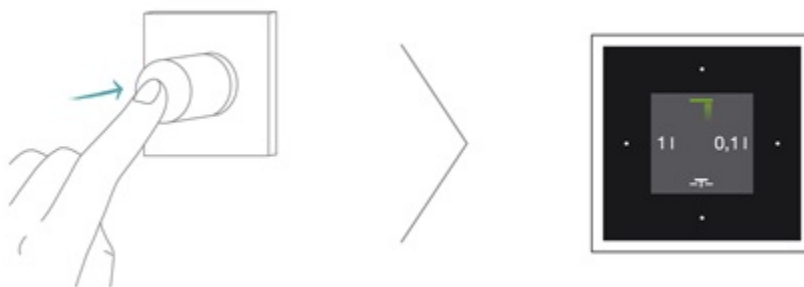

using display button

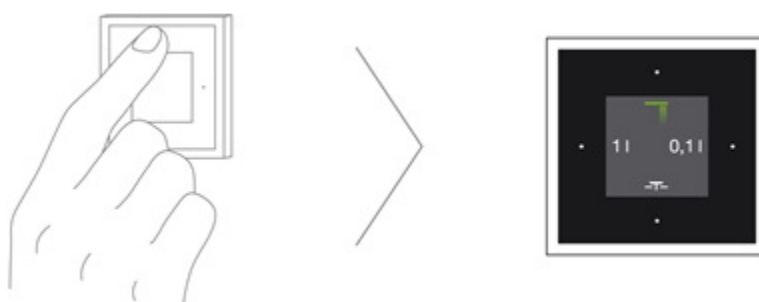

using foot sensor



## Volume adjustment

Volume

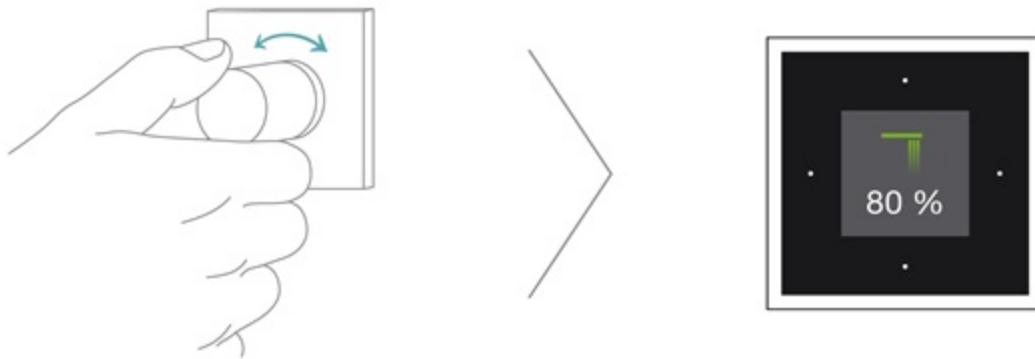

## Temperature adjustment

### Temperature adjustment

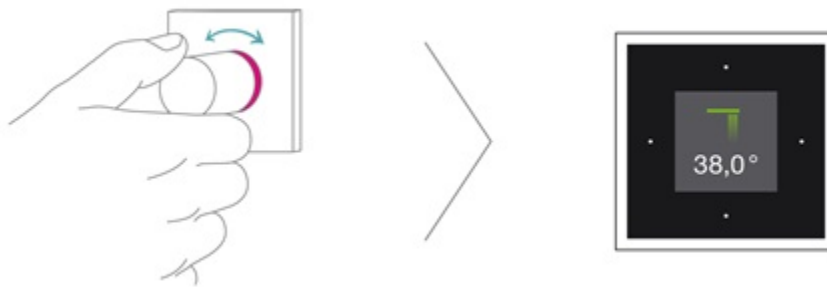

### Disable scalding protection system



1 = turn to max

2= push + turn at the same time

 The scald protection system will be re-enabled after 10 minutes.

## Strainer waste control

Close / Open

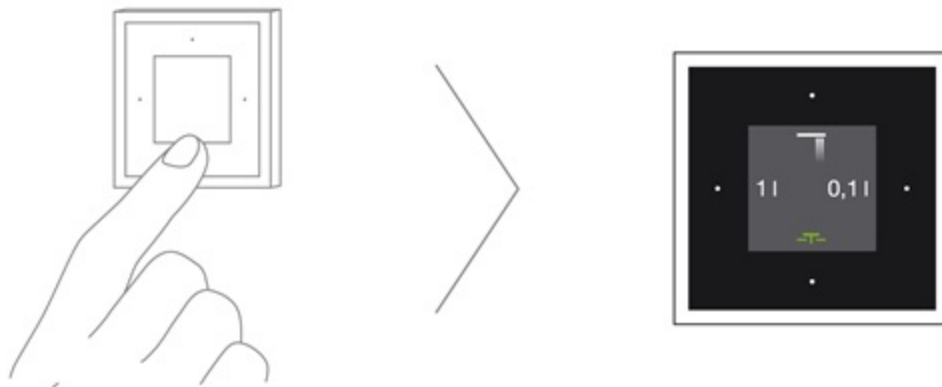

## Flow volume control

Pressing the left key several times enables you to select between 1.0 and 9.0 l.  
Pressing the right key several times enables you to select between 0.1 and 0.9 l.

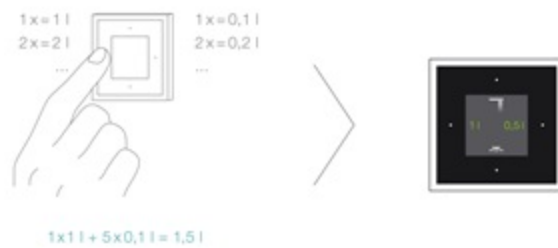

## Cleaning

Key lock

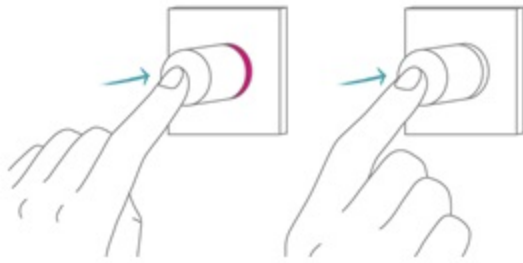

5 sec.



## Service Display

If one of the symbols is lit in red for 2 seconds, contact your dealer or the Dornbracht Service Department.



## Waiting display

If a function has been selected but is not yet ready (e.g. the set temperature), the appropriate symbol will flash. It will stop flashing as soon as the function is ready for use.



## Maintenance

We recommend that you have all the components inspected and serviced by your plumber once per year. This maintenance will also include cleaning, checking for leaks, checking the functions and uploading the latest software version. A maintenance contract with an authorised plumber will ensure that your system is inspected regularly.

## Safety deactivation

A safety deactivation system ensures that all active functions are switched off automatically after 30 minutes at the most.

## Disposal

All electronic elements are marked in compliance with European Directive 2002/96/EC on Waste Electrical and Electronic Equipment (WEEE). This Directive provides the framework for the return and recycling of end of life products throughout the EU. In addition to valuable recyclable materials, end of life electrical and electronic appliances also contain harmful substances. These can be harmful to human health and the environment if they are disposed of in the residual non-recyclable waste or if they are not treated correctly. You should therefore never dispose of your waste appliance as non-recyclable waste. Instead, use the collection point established by your local authority to return and recycle electrical and electronic waste. Ensure that you comply with the current regulations in this respect. You must also comply with other national regulations which apply.



If you have any questions, contact the Dornbracht branch nearest you:

Dornbracht Americas Inc.  
1700 Executive Drive South Suite 600 Duluth, GA 30096  
Tel. +1 (800) 774-1181(770)564-3599, Fax +1 (800) 899-8527  
dornbrachtam@dornbrachtgroup.com